



e-ISSN: 2319-8753 | p-ISSN: 2347-6710

# IJRSET

International Journal of Innovative Research in  
**SCIENCE | ENGINEERING | TECHNOLOGY**

# INTERNATIONAL JOURNAL OF INNOVATIVE RESEARCH

IN SCIENCE | ENGINEERING | TECHNOLOGY

Volume 13, Issue 4, April 2024

**ISSN** INTERNATIONAL  
STANDARD  
SERIAL  
NUMBER  
INDIA

Impact Factor: 8.423

9940 572 462

6381 907 438

[ijirset@gmail.com](mailto:ijirset@gmail.com)

[www.ijirset.com](http://www.ijirset.com)

# A Case Study: Binishells (Thin Shells)

Prof. Shaikh S. J.<sup>1</sup>, Sawan Patel<sup>2</sup>, Akash Rahirao<sup>3</sup>, Bhargavi Shinde<sup>4</sup>, Dhanshree Gomladu<sup>5</sup>, Om Mate<sup>6</sup>

Assistant Professor, Department of Civil Engineering, School of Engineering and Technology, MGM University,  
Chhatrapati Sambhaji Nagar, Maharashtra, India<sup>1</sup>

Students, Department of Civil Engineering, MGM's Polytechnic, Chhatrapati Sambhaji Nagar,  
Maharashtra, India. <sup>2 3 4 5 6</sup>

**ABSTRACT:** Binishells work they use air-supported membranes to mold concrete into sturdy shell structures skipping the need for traditional formwork. This not only saves a ton of time, money, and materials but also offers a fresh take on building compared to old school methods. We also explore the science behind Binishells showing how they are tough and adaptable through real life examples from projects around the globe. Plus, we'll dig into why Binishells are great for the planet, Due to their resource efficiency, energy savings, and ability to withstand disasters. Binishells could get even better with digital tech and fancy materials. Binishell construction is shaking up sustainable architecture by finding a sweet spot between strong structures and eco friendliness.

**KEYWORDS:** Binishell, voila, incorporate sustainable, striking appearance, aesthetically pleasinga, cumbersome

## I. INTRODUCTION

Binishell construction is like a beacon of human creativity and innovation in the world of sustainable architecture. Imagine this back in the 1960s architect Dr. Dante Bini had this wild idea that shook up the way we build things. He came up with the Binishell method, a total game-changer in construction that flips traditional techniques on their head. Binishell construction uses air-supported membranes to shape concrete into strong shell structures. It's kind of like blowing up a balloon, spraying concrete on it and letting it harden into a solid shell. Once the concrete sets you deflate the balloon like membrane and voila You are left with a sturdy building with that signature curved shape.



Fig No 1.0 Binishell,Nicolo Bini,2009,Los Angeles

But here where it gets really cool Binishell construction is super fast and cost effective. Without the need for fancy molds or supports buildings go up quicker and cheaper than with traditional methods. They're not just for looks they distribute weight like a champ making Binishell buildings tough enough to handle earthquakes and extreme weather. Binishells aren't just good for your wallet they are good for the planet too. By using less material and creating less waste they are a win for sustainability. Plus their natural insulation properties mean less energy is needed for heating and cooling.

Binishell construction is getting a lot of attention from architects, engineers, and eco-warriors alike. From cozy homes to massive infrastructure projects, Binishells are showing up all over the place proving that they're adaptable to pretty much any situation. In a world grappling with urbanization, climate change, and dwindling resources, Binishell construction is a shining example of how thinking outside the box can lead to solutions that are both smart and sustainable.

### Engineering Principles of Binishell

Think of blowing up a balloon. That's how Binishells kick off. We start with a big, flexible membrane made of tough fabric or polymer. Then we pump it full of air to create a kind of temporary mold that's shaped like the building we want.



Fig No 2.0 Fabric Or Polymer Flexible Membrane

Next up, we spray concrete onto the inflated membrane. But this isn't just your average concrete mix specially made to be super strong. As we spray the concrete starts to pile up, forming a thick layer over the membrane and taking on its shape. We've got to give the concrete some time to set and harden. This is called curing, and it's where the magic really happens. Just like waiting for cake batter to turn into a yummy cake in the oven we've got to be patient while the concrete becomes solid and sturdy. Once the concrete is good and solid it's time to get rid of the membrane. This is where things get really cool. We deflate the inflated membrane and take it away leaving behind the concrete shell. And because the concrete has hardened it holds its shape all on its own no need for the membrane anymore.



Fig No 3.0 Shotcreting

Despite their delicate beginnings, Binishells are tough cookies once they're fully formed. Their curved shape helps spread out the weight evenly making them super sturdy and able to handle all kinds of challenges like strong winds and earthquakes. Binishell engineering is how it makes building faster and cheaper. Since we don't need all the fancy molds and supports we can put up Binishells much quicker and for less money than regular buildings. Binishells aren't just

strong they're also really versatile. Their curved shape means they can be used for all sorts of buildings from cozy homes to big sports arenas. And because they can handle different climates and environments they're a great option almost anywhere you can think of.

#### Advantages over Conventional Methods

Binishell construction offers numerous advantages over conventional methods. It's notably cost effective due to reduced labor, materials, and time requirements leading to significant cost savings. Its speed of construction is more than traditional methods by the inflatable formwork which allows for rapid assembly and shaping of structures. Binishell structures boost energy efficiency due to their efficient shape and construction materials requiring less energy for heating and cooling. This is enhanced by their natural insulation of the dome shape reducing reliance on artificial heating and cooling systems. From an environmental stand point Binishell construction shines. It generates less waste and uses fewer materials during construction contributing to sustainability. It can incorporate sustainable materials and technologies to minimize environmental impact. The Binishell structures is another advantage as they can various purposes and architectural styles offering customization to meet specific design requirements. Binishell structures have proven facing natural disasters like earthquakes and hurricanes owing to their evenly distributed force absorption capabilities. Binishell structures stand out with their unique visually striking appearance characterized by smooth curved lines setting them apart from traditional structures.



Fig No 4.0 Furnish Binishell

Binishell construction is highly adaptable to different environmental conditions and terrains offering flexibility in design and placement whether in urban or remote areas. Binishell construction presents a compelling alternative to conventional methods providing cost effective, sustainable and resilient building solutions across various applications. Binishell construction brings a host of benefits that outshine traditional building methods in many ways. It's a budget friendly option slashing costs significantly by reducing the need for labor, materials, and time. Thanks to its innovative inflatable formwork structures can be erected swiftly and molded into shape with ease. Energy efficiency is another feather in Binishell's cap. The design and materials used ensure minimal energy consumption for heating and cooling aided by natural insulation from the dome shape. This means less reliance on powerhungry climate control systems reducing both costs and environmental impact. It produces less waste and utilizes fewer materials during construction, making it a sustainable choice. It's adaptable to incorporate eco friendly materials and technologies further minimizing its footprint. The range of needs and architectural styles offering customization options to specific requirements. And when it comes to facing Nature Binishells have proven resilient against earthquakes and hurricanes due to their ability to evenly distribute force. Binishell structures are in a league of their own. Their smooth, curved lines stand out in contrast to traditional boxy buildings, making a bold visual statement. Binishell construction adapts easily to different terrains and environmental conditions making it a viable option for both urban and remote areas. Binishell construction presents a compelling alternative to conventional methods. It's cost effective, sustainable, resilient, and aesthetically pleasing a true all rounder in the world of architecture and construction.

### Future Potential and Innovations

Binishells in sustainable architecture and advanced materials enhancing structural integrity and sustainability paving the way for more resilient and eco friendly structures. Integration with digital technologies like 3D printing and robotics promises faster, innovative designs and cost effective building.



Fig No 5.0 Mud Binishell, Floating Binishell

Smart technologies can optimize energy efficiency and comfort with binishell building make more user friendly and sustainable binishell have the potential to address urgent needs like affordable housing and disaster shelters with their modular construction and rapid deployment the adaptability of binishell to various climates and environments makes them suitable for a wide range of applications from urban developments to remote areas with their ability to withstand extreme weather events and seismic activity binishells resilient housing solution to natural disasters.

In terms of future innovations research into design and sustainable building materials could further enhance the environmental performance of binishells.

### Challenges and Limitations

Binishells in construction comes with its fair share of challenges and limitations that we need to tackle challenge of changing minds of peoples. Many architects, engineers hesitant to shift from traditional building to binishells. Convincing them of the reliable, effectiveness of Binishells take time and effort and design limitations. While Binishells offer flexibility with design, sharp angles or complex geometries. Material availability is another problem, in areas where resources are unavailable or materials are expensive. We need to ensure that suitable materials for Binishell construction are accessible and affordable.

Building Binishells requires special skills and knowledge making workforce training a necessity. We need to invest in educate construction worker to handle Binishell projects effectively. Navigating regulations for Binishell construction can be cumbersome. Streamlining this process and ensuring safety standards are essential. Initial costs of binishell construction might be higher due to special equipment and skill required. The long-term savings make it a worth investment. Ensuring the durability and maintenance of Binishells over time is success or failure. We must develop maintenance practices and construction standards to ensure longevity. Challenging these challenges requires collaboration, innovation, and perseverance. With concerted efforts we can overcome these limitations and unlock the full potential of binishells in sustainable construction.

## II. RELATED WORK

[1]Shells are lightweight, span long distances with minimum use of materials, provide thermal mass and are proved to have a very long design life. In an industry where sustainability has become paramount, and where architecture tends towards dynamic and fluid forms, it is imperative for the engineer to reconsider shells during the design process. [2]The paper illustrates the latest developments in construction techniques and material sciences adopted by the modern shell builders.his paper is the result of the combined work of the two authors. Part 1 was written by Alberto Bologna and part 2 by Alberto Pugnale (Faculty of Architecture, Building and Planning, University of Melbourne). Both parts have been revised by the authors and the paper structure has been conceived together. This research project has been funded by an Early Career Research Project Grant of the Faculty of Architecture, Building and Planning, University of Melbourne, of which Alberto Pugnale is the Chief Investigator. [3]This paper aims to review Dante Bini's career, as well as his form-resistant Binishell and other pneumatic construction systems. The role of Mario

Salvadori in Bini's international success works as the introduction to a broader discussion about the relationship between innovation in design and innovation in construction for shell and gridshell designers. The second part of the paper focuses, instead, on Bini's double profile - architect and builder - which led him to develop his inventions both architecturally and as commercial products. [4]Decades after the empirical hands on approaches adopted by Felix Candela and Heinz Isler, the construction industry finds itself equipped with the tools, materials and know-how needed to bring concrete shells to a new level. The report covers the latest developments in construction techniques, such as inflatable formworks and prefabrication, and material sciences (e.g. Ductal®) adopted by the modern shell builders. [5]The work of architect Dante Bini and in particular his Binishell system for lightweight 'domed' concrete shells developed in the early 1960s was technologically inventive, but remained largely a niche construction product looking for a client. It was arguably the exposure of Bini's ideas following his demonstration Binishell at Columbia University, New York that both legitimised this new technology and launched Bini's career. Throughout that career as variously an architect, inventor and builder Dante Bini has utilised the inexpensive, safe and ubiquitous material of air as a motive force and forming medium. Common to almost all his projects the use of differential air pressure as a means to lift and form heavy materials like concrete embodies an approach, which is both influenced by the great concrete craftsman architect Pier Luigi Nervi and simultaneously the "doing more with less" philosophy of Richard Buckminster Fuller. [6]This report provides information on the construction of structural concrete shells using an inflated form. Major facets of the construction process are covered, including foundations, inflation, monitoring, and backup systems. Other aspects, such as the geometric variations of inflated forms, thickness of polyurethane foam, and mixture proportions for shotcrete, are also considered.

### III. METHODOLOGY

#### 1. Collection of Data

- i. We commenced by accumulating comprehensive information pertaining to Binishells, encompassing their architectural design, construction techniques, and historical implementations.
- ii. Following the initial data gathering phase, we delved into researching the advantages and disadvantages associated with Binishells. This involved a thorough examination of their structural integrity, sustainability features, cost-effectiveness, as well as any potential drawbacks or limitations.
- iii. Subsequently, we meticulously compiled data concerning the current number of Binishell structures in existence up to the present date. This step provided us with valuable insights into the prevalence and adoption rate of Binishell technology within the architectural landscape.
- iv. We conducted further in-depth exploration utilizing online resources such as Google and YouTube. This extended research phase enabled us to gather additional insights, case studies, and expert opinions, enriching our understanding of Binishells from diverse perspectives.

#### 2. Research Paper Analysis on Binishells

- i. Identified and gathered relevant research papers concerning Binishells, focusing on various aspects such as history, design parameters, and construction methodologies.
- ii. Delved into the historical background of Binishells as documented in selected research papers. This involved tracing the origins, evolution, and significant milestones in the development of Binishell technology.
- iii. Sifted through the research papers to extract comprehensive information regarding the design parameters essential for Binishell structures. This included factors such as structural stability, material specifications, and architectural considerations.
- iv. Examined the research papers for detailed descriptions of the step-by-step construction process involved in building Binishells. This encompassed the sequential stages from initial design conceptualization to final construction execution.

#### 3. Construction Process of a Mini Binishell Model

- i. Compiled a detailed list of materials required for constructing the mini Binishell model.
- ii. Acquired essential materials including cement, fine aggregate, plastic balls, binding wire, thin copper wire, oil, and candles.
- iii. Cut the plastic ball according to predetermined specifications for the model.
- iv. Marked the ball surface to indicate the placement of binding wire.
- v. Utilized gauge 21 (0.71 mm) binding wire for structural reinforcement.

- vi. Cut binding wire to proper measurements and affixed it to the marked positions on the ball using thin copper wire.
- vii. Prepared mortar with a ratio of 1 part cement to 2 parts fine aggregate.
- viii. Used 43-grade cement for optimal strength.
- ix. Applied the mortar mixture onto the prepared plastic ball surface.
- x. Allowed the model to cure in a curing tank for a period of 24 hours.



Fig No 6.0 Mini Binishell Model

- xi. Applied cement slurry to the surface to enhance smoothness.
- xii. Affixed paper pieces onto the surface to achieve uniformity.
- xiii. Allowed the model to dry thoroughly after surface treatment.
- xiv. Colored the model to enhance its visual appeal and attractiveness.

#### 4. Construction Process of a Mini Binishell Foundation Model

- i. Constructed formwork using cardboard to delineate the shape of the Binishell foundation.
- ii. Covered the formwork surface with cello tape to ensure waterproofing and prevent leakage.
- iii. Cut binding wire according to specified dimensions for reinforcing the footing.
- iv. Positioned the cut binding wire within the formwork to provide structural reinforcement.



Fig No 7.0 Mini Binishell Foundation Model

- v. Prepared mortar with a ratio of 1 part cement to 2 parts fine aggregate.
- vi. Applied the prepared mortar mixture into the formwork, ensuring even distribution and proper filling.
- vii. Allowed the model of the footing to cure in a curing tank for a period of 24 hours.
- viii. After the curing process, refined the model by removing any excess portions to achieve the desired finish and appearance.

## 5. Construction Process of Interior Design Model for Binishell

- i. Upon completing the mini Binishell model with the foundation model, transitioned to preparing for the interior design model.
- ii. Procured necessary materials and tools for constructing the interior design model, ensuring availability for the project.
- iii. Roughly sketched the model design on paper, incorporating dimensions and layout considerations.
- iv. Transferred the final design onto cardboard, marking out the required pieces for construction.
- v. Using a cutter, precisely cut out the marked pieces from the cardboard.
- vi. Marked the legs of the cut walls on the cardboard to serve as a stable base for the model.

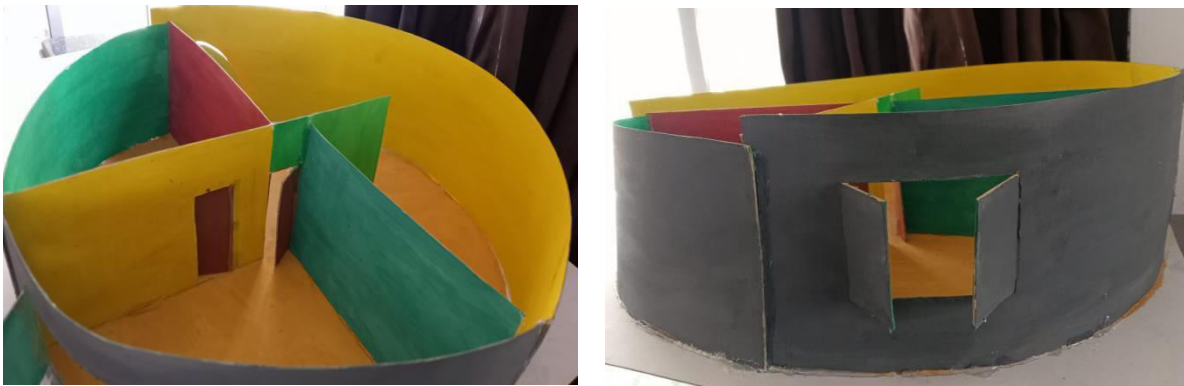

Fig No 8.0 Binishell Interior Design Model

- vii. Cut out openings in the cardboard to simulate entry points for the Binishell structure.
- viii. Applied coloring to the cardboard pieces to enhance visual appeal and realism.
- ix. Utilizing a glue gun, assembled all the cutouts into the desired layout and configuration, ensuring structural integrity.
- x. Integrated miniature furniture pieces into the model to provide a realistic representation of the interior space.

## 6. Planned Furnish Binishell Modal in CAD

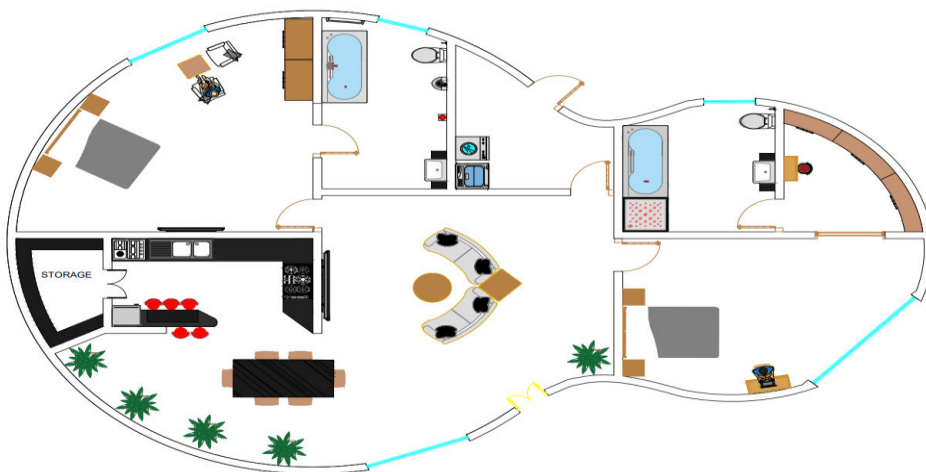

Fig No 9.0 CAD Binishell Modal

Binishell CAD plan had prepared with building principles and laws with all suitable use of furniture and fixtures.





#### IV. CONCLUSION

Binishell structures are cool buildings that show how people can design things. They are different from regular buildings because they are made in a really clever way that saves money and helps the environment. These buildings are tough and they can handle bad weather (storms, earthquake, etc.) without getting damaged easily. Binishell look like big domes which not only makes them strong but also gives them a unique look and even though they are tough they are also nice to look at adding something special to the places they are built. In a world where we are trying to be kinder to the planet. Binishell structures give us hope they remind us that we can build cool stuff while still taking care of the Earth so they are not just buildings they are a sign that we can do amazing things when we put our minds to it.

#### REFERENCES

- [1] Andrea Menardo, Thin Concrete Shells, Research Gate, Volume 4 Issue 3, 2021, 45-51.
- [2] Will Mc Lean , Building With Air, University Of Westminster , Volume 1, 1-18.
- [3] Dante Bini's, Dante Bini's From - Resistant Binishell, University Of Melbourne, Volume 3, 2017, 1-22.
- [4] Andrea Menardo, Morden Method Of Construction And Future Opportunities In The Field Of Thin Concrete Shell, Researchgate, Volume 4 Issue 3, 2021, 65-87.
- [5] Vincenzino E, Culham G, Perry V H, Zakariasen D, Chow T S, First Use of UHPFRC in Thin Precast Concrete Roof Shell for Canadian LRT Station, PCI Journal, Sept-Oct 2005, 50-67.
- [6] Adeeb S M, Scholefield B W J, Brown T G, Shrive N G, Kroman J, Perry V H, Tadros G, Modelling, testing and construction of the first Ductal canopy in the world, Canadian Journal of Civil Engineering 32, 2005: 1152-1165
- [7] Billington, D. P., 1982, Thin Shell Concrete Structures, McGraw-Hill Book Co., Inc., 373 pp.
- [8] Bingham, J. L., 1997, "Bond Strength Between Layers of Shotcrete," MS thesis, Brigham Young University, Provo, Utah, 33 pp.
- [9] Bini, D., 1986, "Thin Shell Concrete Domes," Concrete International, V. 8, No. 1, Jan., pp. 49-53.
- [10] Boyt, J., 1986, "Up, Up and Away," Concrete International, V. 8, No. 1, Jan., pp. 37-40.
- [11] Jacobs, S. E., 1996, "Large Diameter Low Profile Air Forms Using Cable Net Support Systems For Concrete Domes," MS thesis, Brigham Young University, Provo, Utah, 117 pp.
- [12] Neff, W., 1942, United States Patent No. 2,270,229. Peterson, G. P., 1998, "Pull-Out Testing of Cast in Place
- [13] South, D. B., 1990, "Economics and the Thin Shell Dome," Concrete International, V. 12, No. 8, Aug., pp. 18-20.
- [14] South, J. P., 1996, "Preliminary Analysis and Design of Large Span Air Formed Concrete Domes," MS thesis, Brigham Young University, Provo, Utah, 118 pp.



INTERNATIONAL  
STANDARD  
SERIAL  
NUMBER  
INDIA



# INTERNATIONAL JOURNAL OF INNOVATIVE RESEARCH

IN SCIENCE | ENGINEERING | TECHNOLOGY

 9940 572 462  6381 907 438  [ijirset@gmail.com](mailto:ijirset@gmail.com)



[www.ijirset.com](http://www.ijirset.com)

Scan to save the contact details